

# 90° DUAL PLANE Swivels

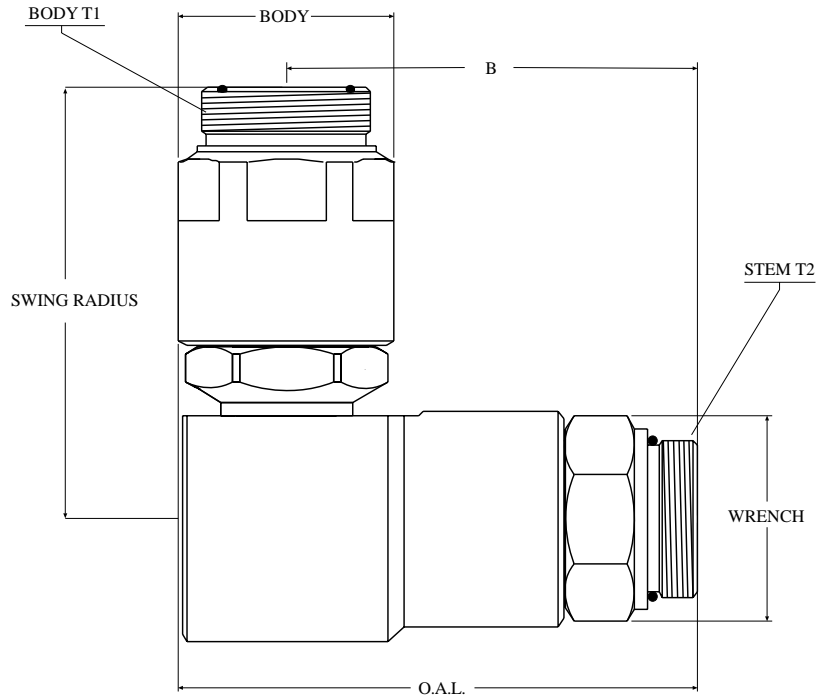

## Male O-Ring(O.R.B.) x Male Face Seal(M.F.S.)

Not Available  
In Stainless Steel!



PART NUMBER	O.A.L.	B DIM.	BODY	WRENCH	BODY T1	STEM T2	SWING RADIUS	MAX PSI	THRU HOLE
9 DP 4 MO 6 X MFS 6	2.792	2.215	1.000	0.750	11/16-16 UN	9/16-18 UN	2.609	5000	0.250
9 DP 8 MO 8 X MFS 8	3.169	2.376	1.375	1.000	13/16-16 UN	3/4-16 UN	2.912	5000	0.297
9 DP 8 MO 10 X MFS 10	3.291	2.498	1.375	1.000	1-14 UN	7/8-14 UN	3.018	5000	0.291
9 DP 12 MO 12 X MFS 12	3.615	2.749	1.500	1.375	1 3/16-12 UN	1 1/16-12 UN	3.239	4500	0.391
9 DP 16 MO 16 X MFS 16	4.370	3.411	1.750	1.625	1 7/16-12 UN	1 5/16-12 UN	3.970	4000	0.484
9 DP 20 MO 20 X MFS 20	4.934	3.755	2.125	1.875	1 11/16-12 UN	1 5/8-12 UN	4.446	4000	0.718
9 DP 24 MO 24 X MFS 24	6.149	4.875	2.375	2.125	2-12 UN	1 7/8-12 UN	5.116	4000	0.844