

Male Face Seal Bulkhead (M.F.S.B.) x Male Face Seal (M.F.S.)

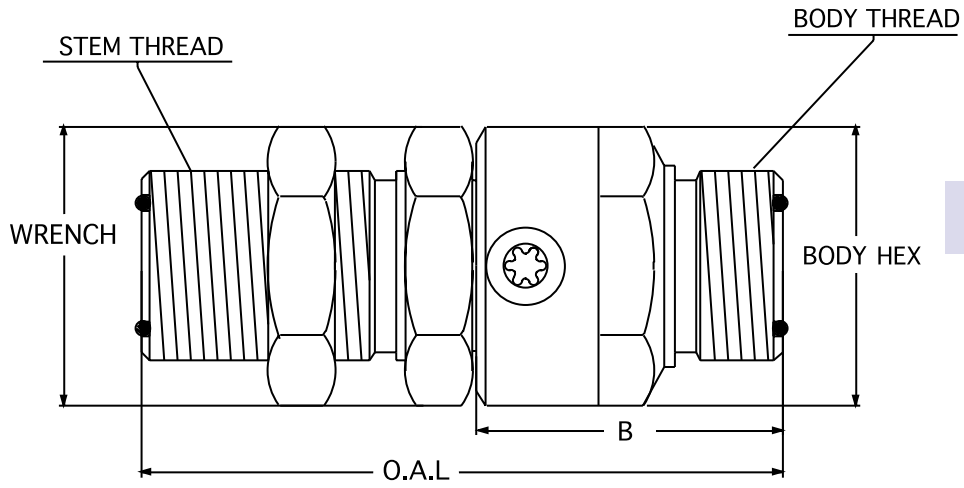

Not Available
In Stainless Steel!

PART NUMBER	O.A.L.	DIM. B	STEM THREAD	BODY THREAD	STEM HEX	BODY HEX/WRENCH	MAX P.S.I.G.	THROUGH HOLE
SS 4 MFSB 6 X MFS 6	3.320	1.640	11/16-16 U.N.	11/16-16 U.N.	1.000	1.000	5000	.250
SS 8 MFSB 8 X MFS 8	3.529	1.709	13/16-16 U.N.	13/16-16 U.N.	1.125	1.375	5000	.390
SS 8 MFSB 10 X MFS 10	3.895	1.815	1 -14 U.N.	1-14 U.N.	1.125	1.375	5000	.484
SS 12 MFSB 12 X MFS 12	3.980	1.900	1 ³ / ₁₆ -12 U.N.	1 ³ / ₁₆ -12 U.N.	1.500	1.500	4500	.609
SS 16 MFSB 16 X MFS 16	4.450	2.360	1 ⁷ / ₁₆ -12 U.N.	1 ⁷ / ₁₆ -12 U.N.	1.750	1.750	4000	.811
SS 20 MFSB 20 X MFS 20	4.640	2.500	1 ¹¹ / ₁₆ -12 U.N.	1 ¹¹ / ₁₆ -12 U.N.	2.000	2.125	4000	1.024