

# Female Pipe (N.P.T.) X J.I.C. Swivel Nut (37°)

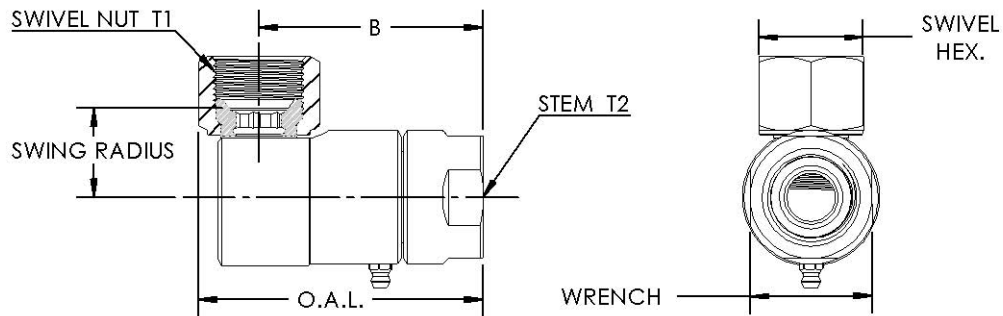

Not Available  
In Stainless Steel!

PART NUMBER	O.A.L.	DIM. B	SWIVEL HEX	WRENCH/HEX	SWIVEL NUT T1	STEM T2	SWG. RADIUS	MAX P.S.I.G.	THROUGH HOLE
9 SS 4 FP 25 X FJS 4	2.757	2.245	0.562	0.875	7/16-20 U.N.	1/4-18 N.P.T.	1.171	3500	0.165
9 SS 4 FP 25 X FJS 6	2.757	2.245	0.687	0.875	9/16-18 U.N.	1/4-18 N.P.T.	1.167	3500	0.250
9 SS 8 FP 38 X FJS 6	2.970	2.423	0.687	1.120	9/16-18 U.N.	3/8-18 N.P.T.	1.283	3500	0.290
9 SS 8 FP 50 X FJS 8	2.970	2.423	0.875	1.245	3/4-16 U.N.	1/2-14 N.P.T.	1.254	3500	0.290
9 SS 8 FP 50 X FJS 10	3.003	2.423	1.000	1.245	7/8-14 U.N.	1/2-14 N.P.T.	1.017	4500	0.320
9 SS 12 FP 75 X FJS 12	3.231	2.51	1.250	1.495	1 1/16-12 U.N.	3/4-14 N.P.T.	1.040	4500	0.460
9 SS 16 FP 100 X FJS 16	4.077	3.212	1.500	1.745	1 5/16-12 U.N.	1-11 1/2 N.P.T.	1.277	4000	0.650
9 SS 20 FP 125 X FJS 20	4.827	3.67	2.00	2.120	1 5/8-12 U.N.	1 1/4-11 1/2 N.P.T.	1.403	4000	0.790
9 SS 24 FP 150 X FJS 24	5.959	4.66	2.250	2.375	1 7/8-12 U.N.	1 1/2-11 1/2 N.P.T.	1.699	4000	0.920